



1 inch MEGAPIXEL Machine Vision Lens

IMX183
1" 2.4 μ m

IMX255
1" 3.45 μ m

IMX267/305
1" 3.45 μ m

EV2S12M
1" 2.8 μ m

XGS12000
1" 3.2 μ m

CMV4000
1" 5.5 μ m



MPZ Series

- Compact & Light Weight
- Shorter Working Distance
- Floating Design
- Nominal Distortion Design
- Ensure Corner Brightness
- Vibration Resistance : 5G



1 Inch MEGAPIXEL Machine Vision Lens MPZ Series



V0826-MPZ

Focal Length	8mm	Distortion	1 Type	-0.8%			
Max. Aperture Ratio	1:2.6		2/3 Type	-2.1%			
Max. Image Format	12.8mm x 9.6mm(ϕ 16mm)		1/1.8 Type	-1.9%			
Operation Range	Iris F2.6 - F16.0	Filter Size	-				
	Focus 0.1m - Inf.	Weight	TBD				
Angle of View	D	1 Type	88.8°	2/3 Type	68.6°	1/1.8 Type	58.2°
	H		76.9°		57.1°		47.8°
	V		61.5°		44.2°		36.6°
Operation Temperature	-10°C - +50°C		M.O.D. : Minimum Object Distance				

Dimensions

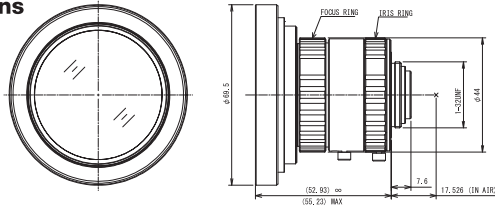

V1624-MPZ

Focal Length	16mm	Distortion	1 Type	0.0%			
Max. Aperture Ratio	1:2.4		2/3 Type	-0.4%			
Max. Image Format	12.8mm x 9.6mm(ϕ 16mm)		1/1.8 Type	-0.4%			
Operation Range	Iris F2.4 - F16.0	Filter Size	M33.5 P=0.5mm				
	Focus 0.1m - Inf.	Weight	TBD				
Angle of View	D	1 Type	53.2°	2/3 Type	38.1°	1/1.8 Type	31.6°
	H		43.8°		30.9°		25.5°
	V		33.6°		23.4°		19.2°
Operation Temperature	-10°C - +50°C		M.O.D. : Minimum Object Distance				

Dimensions

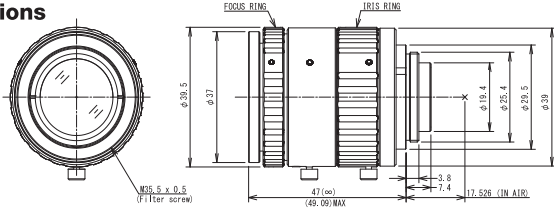

V3522-MPZ

Focal Length	35mm	Distortion	1 Type	0.0%			
Max. Aperture Ratio	1:2.2		2/3 Type	0.0%			
Max. Image Format	12.8mm x 9.6mm(ϕ 16mm)		1/1.8 Type	0.0%			
Operation Range	Iris F2.2 - F16.0	Filter Size	M34 P=0.5mm				
	Focus 0.2m - Inf.	Weight	118.2g				
Angle of View	D	1 Type	25.8°	2/3 Type	17.9°	1/1.8 Type	14.7°
	H		20.8°		14.4°		11.8°
	V		15.7°		10.8°		8.9°
Operation Temperature	-10°C - +50°C		M.O.D. : Minimum Object Distance				

Dimensions

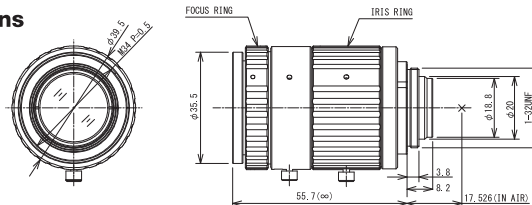

V7531-MPZ

Focal Length	75mm	Distortion	1 Type	0.0%			
Max. Aperture Ratio	1:3.1		2/3 Type	0.0%			
Max. Image Format	12.8mm x 9.6mm(ϕ 16mm)		1/1.8 Type	0.0%			
Operation Range	Iris F3.1 - F16.0	Filter Size	M30.5 P=0.5mm				
	Focus 0.25m - Inf.	Weight	TBD				
Angle of View	D	1 Type	12.2°	2/3 Type	8.4°	1/1.8 Type	6.9°
	H		9.8°		6.7°		5.5°
	V		7.3°		5.0°		4.1°
Operation Temperature	-10°C - +50°C		M.O.D. : Minimum Object Distance				

Dimensions

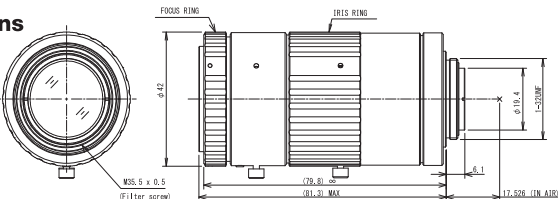

V1226-MPZ

Focal Length	12mm	Distortion	1 Type	0.0%			
Max. Aperture Ratio	1:2.6		2/3 Type	-1.1%			
Max. Image Format	12.8mm x 9.6mm(ϕ 16mm)		1/1.8 Type	-1.0%			
Operation Range	Iris F2.6 - F16.0	Filter Size	M37.5 P=0.5mm				
	Focus 0.1m - Inf.	Weight	98.4g				
Angle of View	D	1 Type	67.4°	2/3 Type	49.8°	1/1.8 Type	41.5°
	H		56.7°		40.7°		33.7°
	V		44.1°		31.0°		25.5°
Operation Temperature	-10°C - +50°C		M.O.D. : Minimum Object Distance				

Dimensions

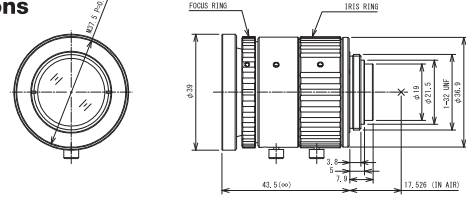

V2520-MPZ

Focal Length	25mm	Distortion	1 Type	0.0%			
Max. Aperture Ratio	1:2.0		2/3 Type	0.0%			
Max. Image Format	12.8mm x 9.6mm(ϕ 16mm)		1/1.8 Type	0.0%			
Operation Range	Iris F2.0 - F16.0	Filter Size	M35.5 P=0.5mm				
	Focus 0.15m - Inf.	Weight	73.1g				
Angle of View	D	1 Type	35.5°	2/3 Type	24.9°	1/1.8 Type	20.5°
	H		28.8°		20.0°		16.4°
	V		21.8°		15.1°		12.4°
Operation Temperature	-10°C - +50°C		M.O.D. : Minimum Object Distance				

Dimensions

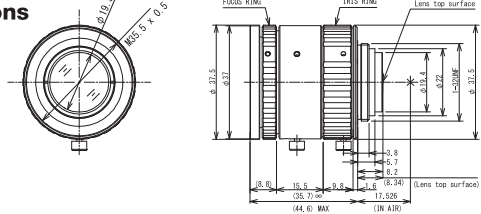

V5024-MPZ

Focal Length	50mm	Distortion	1 Type	0.0%			
Max. Aperture Ratio	1:2.4		2/3 Type	0.0%			
Max. Image Format	12.8mm x 9.6mm(ϕ 16mm)		1/1.8 Type	0.0%			
Operation Range	Iris F2.4 - F16.0	Filter Size	M30.5 P=0.5mm				
	Focus 0.2m - Inf.	Weight	138.5g				
Angle of View	D	1 Type	18.2°	2/3 Type	12.6°	1/1.8 Type	10.3°
	H		14.6°		10.1°		8.3°
	V		11.0°		7.6°		6.2°
Operation Temperature	-10°C - +50°C		M.O.D. : Minimum Object Distance				

Dimensions

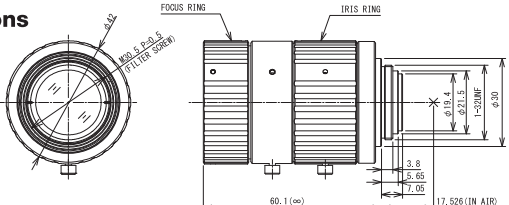

CBC AMERICA LLC
North Carolina
 2000 Regency parkway, Suite 600
 Cary, NC, 27518, U.S.A.
 TEL : +1 919 230 8700
 FAX : +1 919 230 2268
 computar@cbcamerica.com
 computar.com

CBC Co.,Ltd.
 BDM Div, Industrial Optics Department
 2-15-13, Tsukishima, Chuo-ku, Tokyo, 104-0052, Japan
 TEL:+81(0)3 3536 4766 FAX:+81(0)3 3536 4172
www.computar-global.com